

KIT FEATURES

- ▶ Equalizer provisions
- ▶ Rear support provisions

KIT COMPONENTS

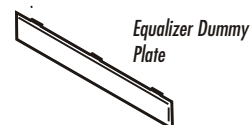
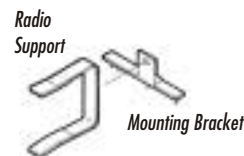
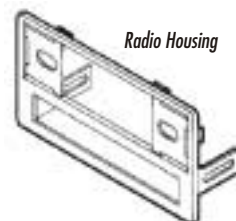

TOOLS REQUIRED



99-7888 DW-7888 INSTALLATION INSTRUCTIONS

APPLICATIONS

CAR	PAGE
ACURA	
Integra 1990-93.....	1
Integra 1994-01.....	1
Legend 1990.....	2
Legend 1991-96.....	3
TL 1996-98.....	2
Vigor 1992-94.....	3
HONDA	
Accord 1990-93.....	4
Odyssey 1995-98.....	4
Prelude 1988-91.....	4
ISUZU	
Oasis 1996-99.....	4

ACURA Integra 1990-93

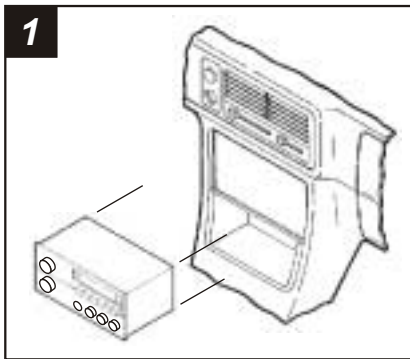

Disconnect the negative battery terminal to prevent an accidental short circuit. Remove (3) screws from each side of the center console and remove the console. Remove (2) screws securing the factory head unit to the sub-dash support bracket. Slide the head unit/pocket assembly out and disconnect the wiring.

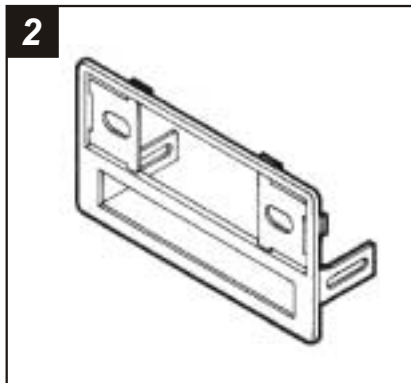

Locate the **Radio Housing**. Skip to the *Installation Instructions for ALL VEHICLES on Page #5*.

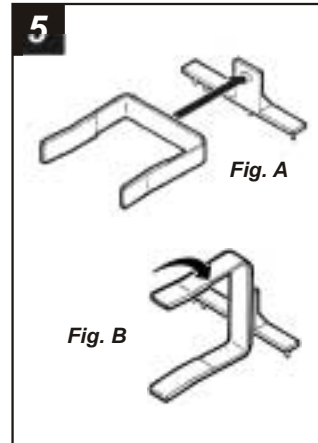

Insert the **Radio Support** into the **Mounting Bracket**. (see Fig. A). Turn the Radio Support to lock into place. (see Fig. B)

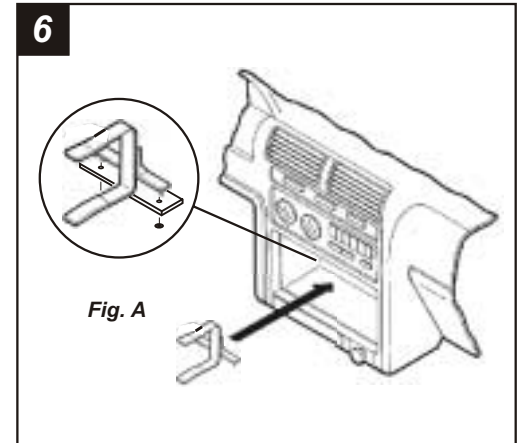

Mount the assembly to the factory mounting plate in the sub-dash with (2) **Pal Nuts** supplied. (see Fig. A)

ACURA Integra 1994-00

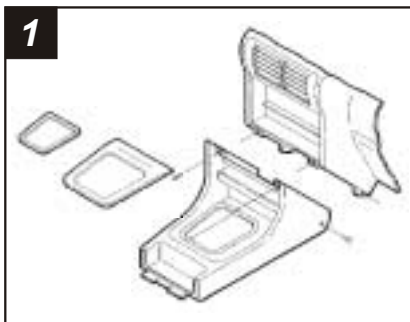

Disconnect the negative battery terminal to prevent an accidental short circuit. Remove the cover cap located under the emergency brake and remove (2) screws exposed. Remove (2) screws from the rear corners of the lower dash trim bezel and remove. Remove the ashtray and (2) screws exposed. Unsnap the ashtray housing and disconnect the cigarette lighter harness. Remove the gear shifter knob and unsnap the shifter trim. Remove (2) screws below the radio opening and remove the upper dash trim bezel. Remove (2) 8mm screws securing the factory head unit and disconnect the wiring.

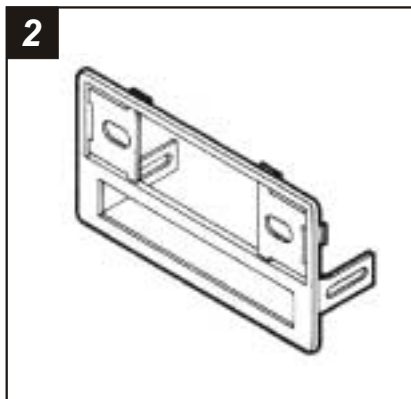

Locate the **Radio Housing**. Skip to the *Installation Instructions for ALL VEHICLES on Page #5*.

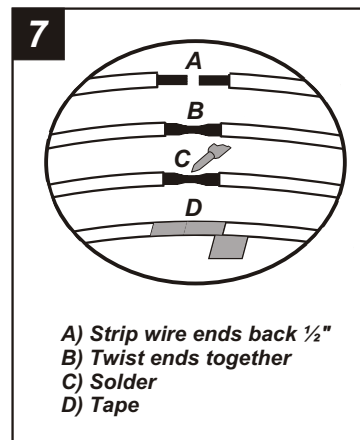

Locate the factory wiring harness in the dash. Metra recommends using the proper mating adaptor and making connections as shown. (Isolate and individually tape off the ends of any unused wires to prevent electrical short circuit).

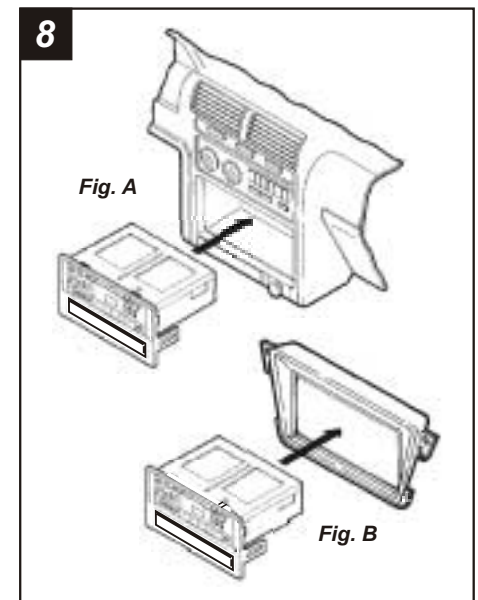

INTEGRA, ACCORD, ODYSSEY, OASIS: Re-connect the battery terminal and test the unit for proper operation. Snap the head unit/kit assembly into the sub-dash. (see Fig. A)

LEGEND, TL, VIGOR: Re-connect the battery terminal and test the unit for proper operation. Snap the head unit/kit assembly into the factory trim bezel. Mount the bezel to the dash with those screws previously removed in step #1. (see Fig. B)

ALL VEHICLES

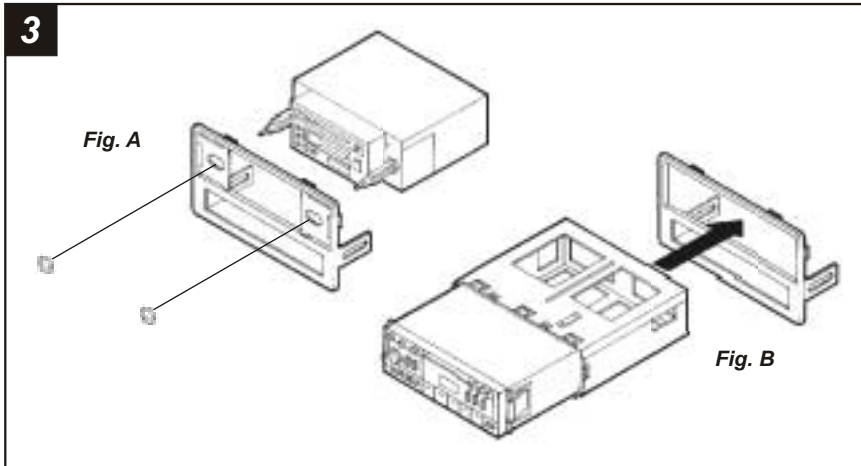

2-SHAFT HEAD UNITS: Slide the aftermarket head unit into the kit and secure with shaft nuts. (see Fig. A)

DIN HEAD UNITS: Cut and remove the shaft supports from the **Radio Housing**. Slide the DIN cage into the kit and secure by bending the metal locking tabs down. Slide the aftermarket head unit into the cage until secure. (see Fig. B)

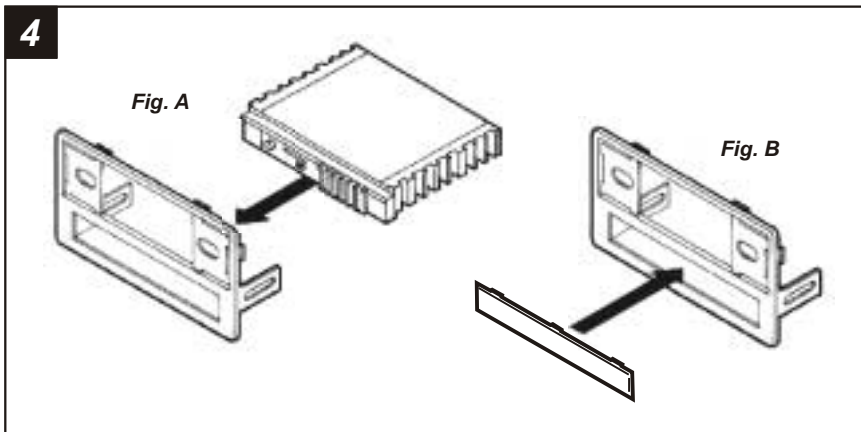

IF AN EQUALIZER WILL BE INCLUDED: Slide the aftermarket equalizer into the back of the **Radio Housing**. Using the hardware included with the equalizer, mount the unit to the kit. (see Fig. A)

IF AN EQUALIZER WILL NOT BE INCLUDED: Snap the **Equalizer Dummy Plate** into the **Radio Housing**. (see Fig. B)

ACURA TL 1996-98

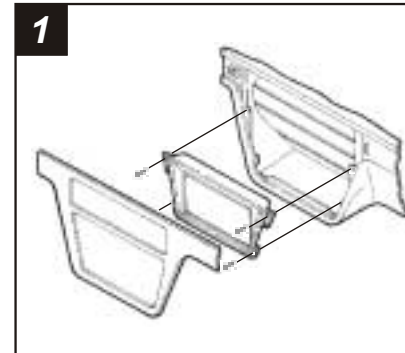

Disconnect the negative battery terminal to prevent an accidental short circuit. Using a small screwdriver, unclip the perimeter of the radio trim bezel. Disconnect the climate control and rear defroster wiring and remove the bezel. Remove (4) Phillips screws securing the factory head unit/trim bezel assembly. Loosen (2) Phillips screws securing the back of the head unit to the metal housing and slide the unit out. (It is NOT necessary to remove the screws securing the metal housing to the bezel). Disconnect the wiring.

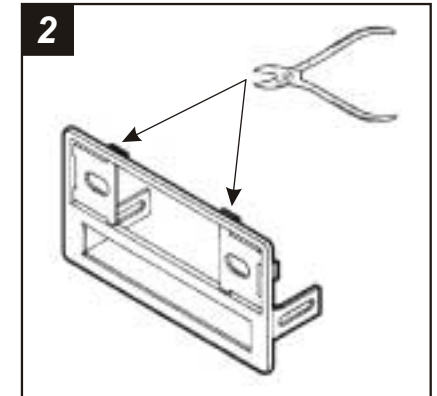

Cut and remove the **TOP** clips from the **Radio Housing**. Skip to the *Installation Instructions for ALL VEHICLES on Page #5*.

ACURA Legend 1990

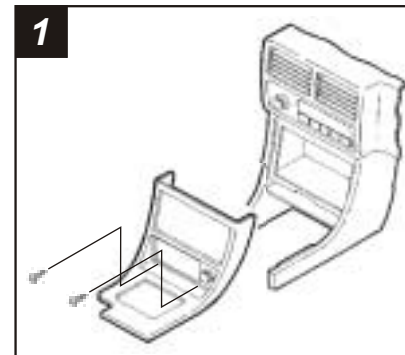

Disconnect the negative battery terminal to prevent an accidental short circuit. Remove (2) screws below the ashtray. Unclip the dash trim bezel. Disconnect the cigarette lighter wiring and remove the bezel. Remove (2) bolts securing the rear of the factory head unit and disconnect the wiring.

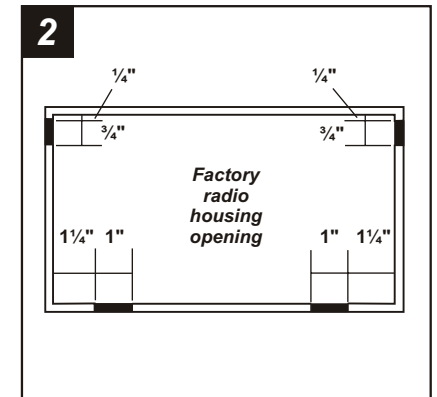

Modify the factory radio housing by cutting and removing the shaded portions of the housing lip. Skip to the *Installation Instructions for ALL VEHICLES on Page #5*.

ACURA Legend 1991-96

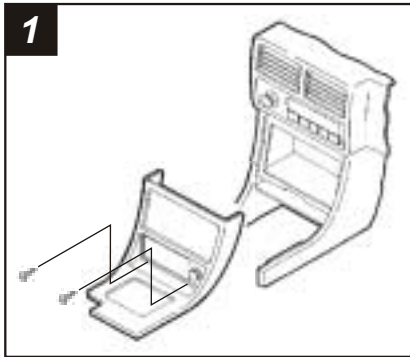

1
Disconnect the negative battery terminal to prevent an accidental short circuit. Remove (2) screws below the ashtray. Unclip the dash trim bezel. Disconnect the cigarette lighter wiring and remove the bezel. Remove (2) bolts securing the rear of the factory head unit and disconnect the wiring.

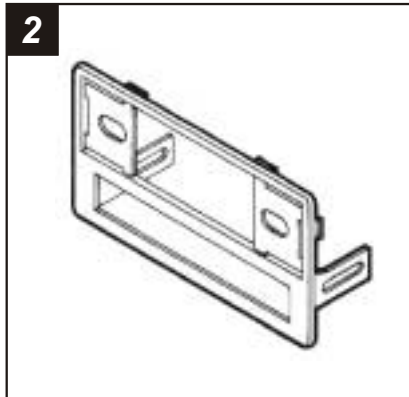

2
Locate the **Radio Housing**. Skip to the *Installation Instructions for ALL VEHICLES on Page #5*.

ACURA Vigor 1992-94

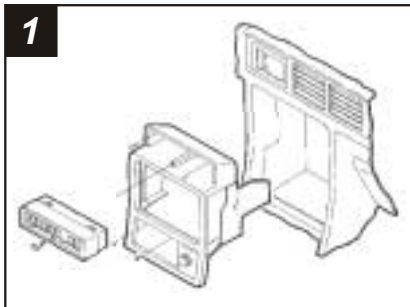

1
Disconnect the negative battery terminal to prevent an accidental short circuit. Remove the access cap from the climate control cluster and (1) screw exposed. Unclip the cluster and remove (2) screws exposed. Remove the ashtray and (2) Phillips screws exposed. Remove the cover caps from each front corner of the center console and the screws exposed. Open the storage compartment, lift up the carpet and remove (2) screws exposed. Lift up on the center console and remove. Unclip the radio trim bezel and disconnect the wiring. Remove (2) bolts from the back of the factory head unit and disconnect the wiring.

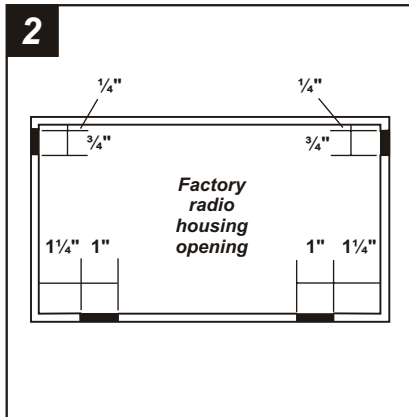

2
Modify the factory radio housing by cutting and removing the shaded portions of the housing lip. Skip to the *Installation Instructions for ALL VEHICLES on Page #5*.

HONDA Accord 1990-93

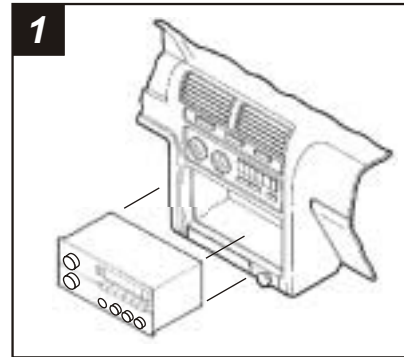

1
Disconnect the negative battery terminal to prevent an accidental short circuit. Remove (4) screws from the lower portion of the center console. Remove the gear shifter knob and lift the console out. Remove the ashtray and ashtray bracket. Remove (2) screws from the bottom of the head unit support, slide the unit out and disconnect the wiring.

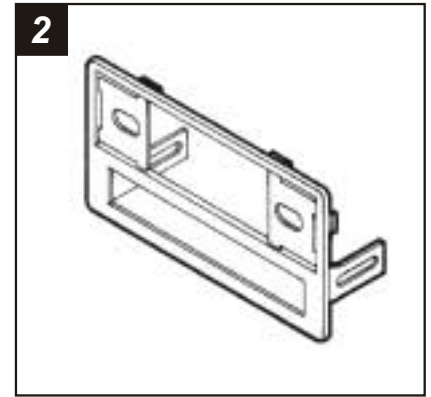

2
Locate the **Radio Housing**. Skip to the *Installation Instructions for ALL VEHICLES on Page #5*.

HONDA Odyssey 1995-98 / ISUZU Oasis 1996-99

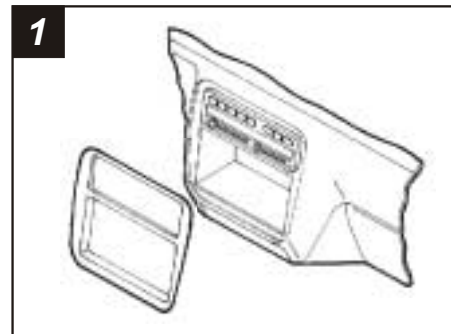

1
Disconnect the negative battery terminal to prevent an accidental short circuit. Remove (2) 8mm screws under the glove box. Remove (1) Phillips screw on the glove box arm and remove the box. Remove (2) Phillips screws exposed in the glove box cavity. Remove (2) Phillips screws below the storage box door (under the ashtray). Remove (2) screws from the left side of the dash console. Remove (1) Phillips screw from the coin tray. Remove (1) Phillips screw under the ignition. Remove (4) Phillips screws securing the factory cupholder. Remove (2) 8mm hex-head screws from the rear support bracket and disconnect the wiring.

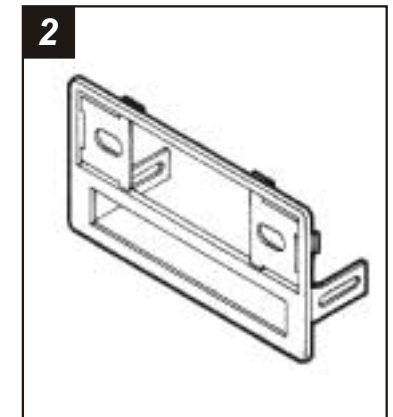

2
Locate the **Radio Housing**. Skip to the *Installation Instructions for ALL VEHICLES on Page #5*.