

KIT FEATURES

- ▶ ISO and DIN head unit provisions
- ▶ Pocket
- ▶ Rear Support

KIT COMPONENTS

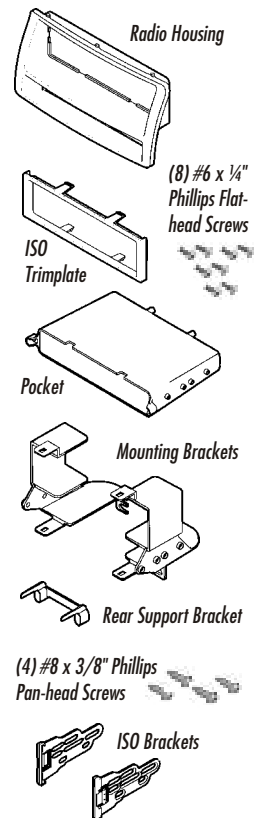

TOOLS REQUIRED



99-8204

INSTALLATION INSTRUCTIONS

APPLICATIONS

CAR	PAGE
TOYOTA	
Corolla 2003.....	1-2



ALL VEHICLES

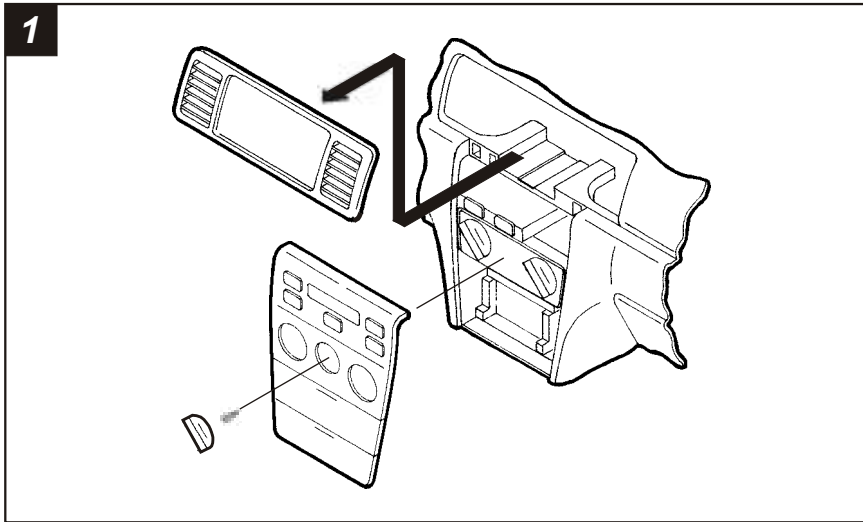

Disconnect the negative battery terminal to prevent an accidental short circuit. Unsnap the gear shifter trim bezel and remove. Remove the center climate control knob and (1) Phillips screw exposed. Unclip the climate control bezel/pocket assembly and remove. Remove (4) 10 mm bolts from the bottom of the factory head unit. Remove the factory head unit/trim bezel assembly and disconnect the wiring. Unclip the bezel from the head unit and remove the unit.

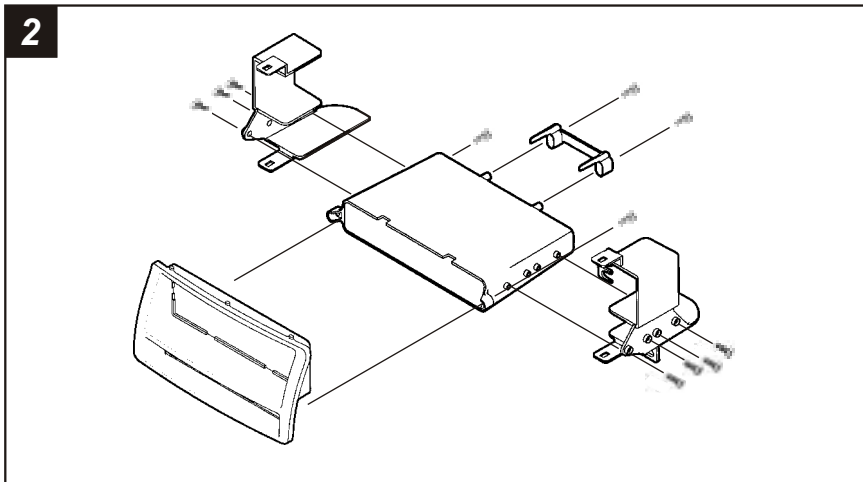

Attach the **Pocket** to the back of the **Radio Housing** (by holding the Housing upside-down, inserting the right edge of the Pocket into place and pushing the rest of the Pocket onto the lip) and mount with (2) #8 x 3/8" Phillips Pan-head Screws supplied. Secure the **Mounting Brackets** to the Pocket with (8) #6 x 1/4" Phillip Flat-head Screws supplied. Mount the **Rear Support Bracket** to the back of the Pocket with (2) #8 x 3/8" Phillips Pan-head Screws supplied.

1

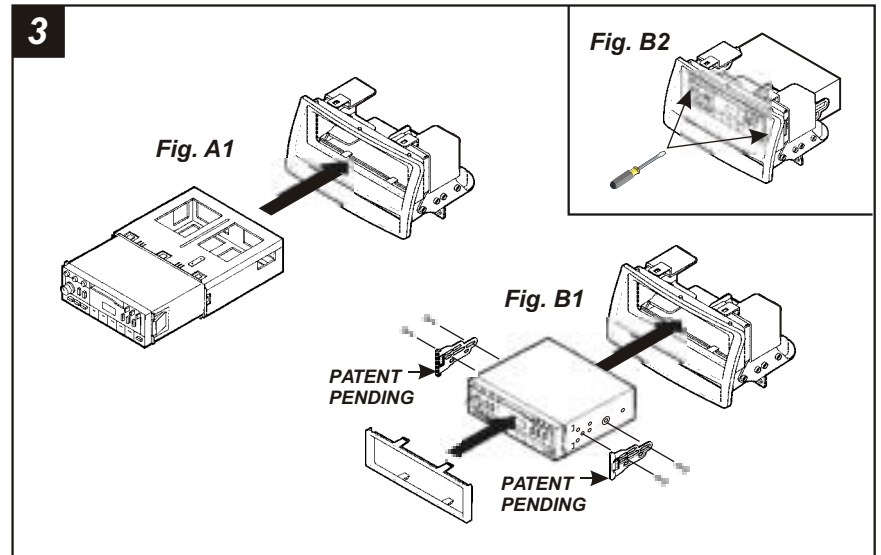

DIN HEAD UNITS: Slide the DIN cage into the **Radio Housing** and secure by bending the metal locking tabs down. Slide the aftermarket head unit into the cage and secure. (see Fig. A1)

ISO HEAD UNITS: Align the holes in the **ISO Brackets** with the holes in the head unit and mount the Brackets to the head unit with the screws supplied with the unit. Slide the head unit/bracket assembly into the radio opening until the side clips engage and snap the **ISO Trimplate** over the unit (see Fig. B1). **NOTE:** To remove the mounted head unit, unclip and remove the ISO Trimplate. Using a small flat-blade screwdriver, disengage the side clips securing the ISO Brackets to the Radio Housing (see Fig. B2).

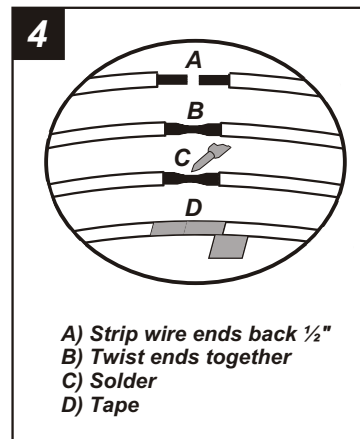

Locate the factory wiring harness in the dash. Metra recommends using the proper mating adaptor and making connections as shown. (Isolate and individually tape off the ends of any unused wires to prevent electrical short circuit).

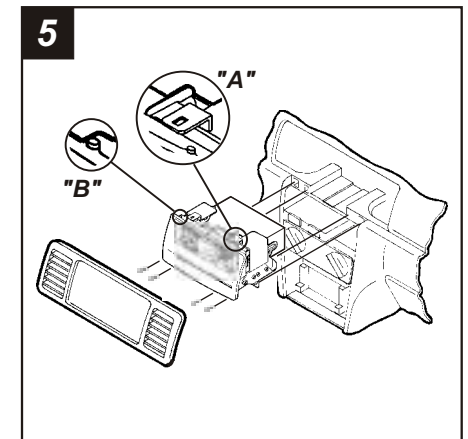

Re-connect the battery terminal and test the unit for proper operation. Snap the factory head unit trim bezel over the kit by engaging the (4) bracket tabs ("A") and (3) Housing bosses ("B") to the back of the bezel. Slide the assembly into the sub-dash and mount with (4) 10 mm bolts previously removed in step #1. Re-assemble the dash.

2