

KIT FEATURES

- ▶ DIN head unit provisions
- ▶ Pocket

KIT COMPONENTS

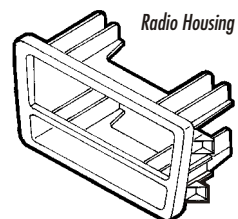

TOOLS REQUIRED



Phillips screwdriver



Panel removal tool



Small flat-blade screwdriver

99-8710

INSTALLATION INSTRUCTIONS

APPLICATIONS

| CAR | PAGE |
|----------------------|-------------|
| MERCEDES | |
| C-Class 2001-02..... | 1-2 |



ALL VEHICLES

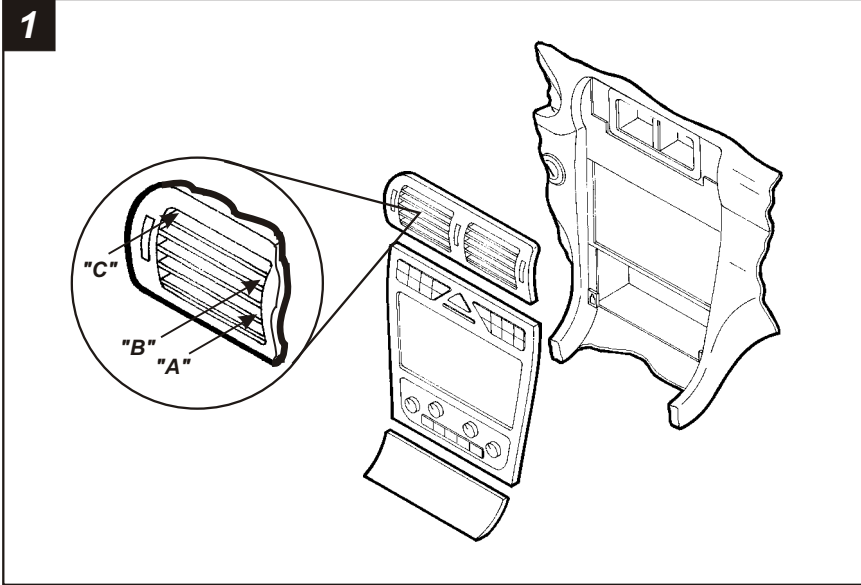

Disconnect the negative battery terminal to prevent an accidental short circuit. Unsnap the gear shifter trim (with gear indicators). Unclip the console trim bezel and remove. Remove the ashtray insert. Remove the ashtray assembly by releasing (2) plastic clips on the bottom lip of the assembly. Unclip (2) metal clips along the bottom edge of the radio/climate control trim bezel and remove the bezel. Using a small screwdriver, push the lower clip ("A") inward and rotate the vent upward to expose (1) torx-head screw. Loosen the torx-head screw. (It is NOT necessary to remove the screw). Using a small screwdriver, push the upper clip ("B") inward and rotate the vent downward to expose (1) spring clip in the top corner ("C"). Push down on the spring clip, pull out on the vent assembly and remove. (Repeat steps for other vent). Remove (2) Phillips screws securing the factory head unit and disconnect the wiring.

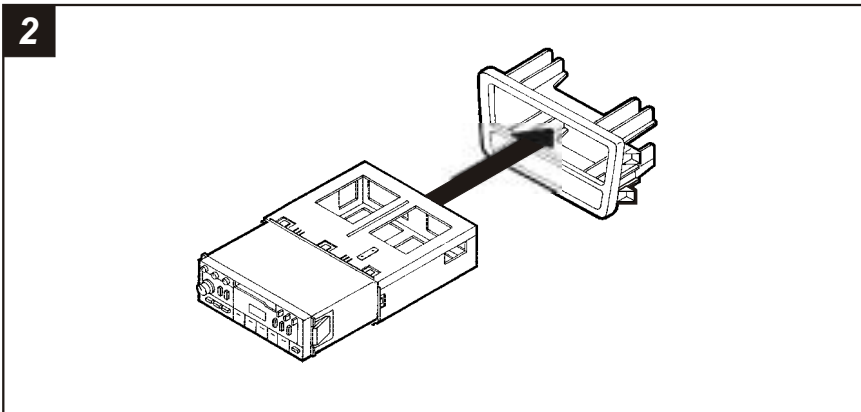

Slide the DIN cage into the radio opening until the side clips engage. Slide the DIN head unit into the cage until secure.

1

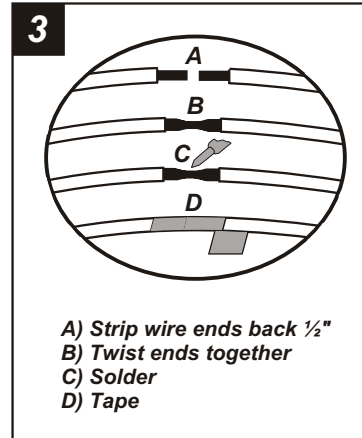

Locate the factory wiring harness in the dash. Metra recommends using the proper mating adaptor and making connections as shown. (Isolate and individually tape off the ends of any unused wires to prevent electrical short circuit).

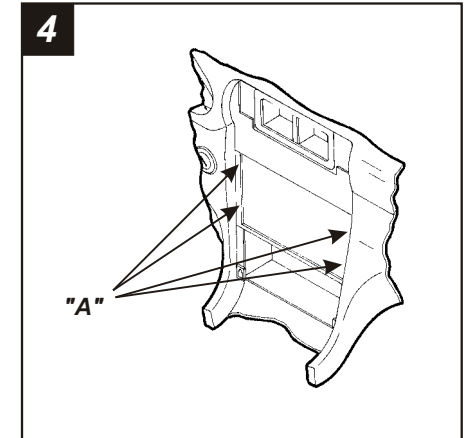

Locate the (4) mounting positions in the sub-dash ("A").

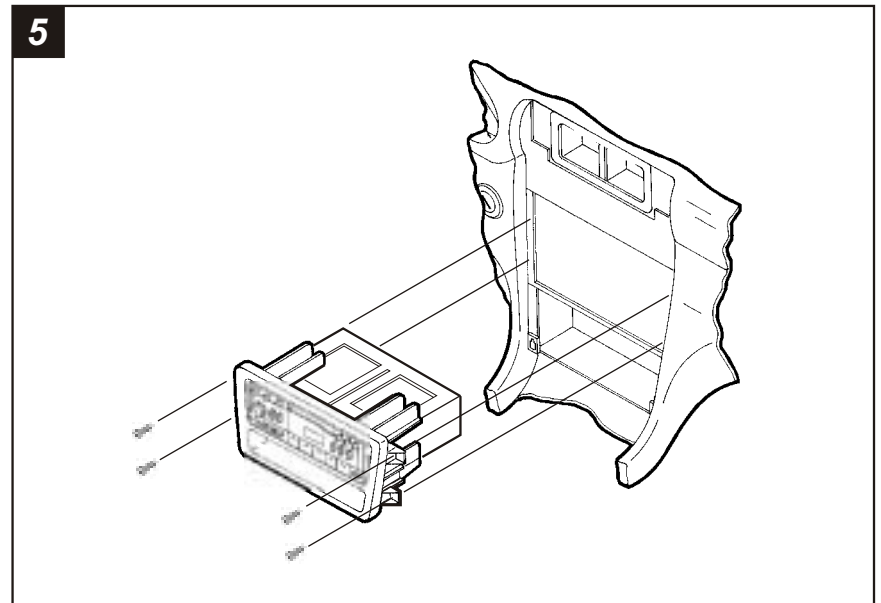

Re-connect the battery terminal and test the unit for proper operation. Mount the head unit/kit assembly to the sub-dash with (4) Phillips screws.

2