

KIT FEATURES

- ▶ Shaft, DIN and ISO-DIN unit provisions
- ▶ Various mounting depth alternatives

KIT COMPONENTS

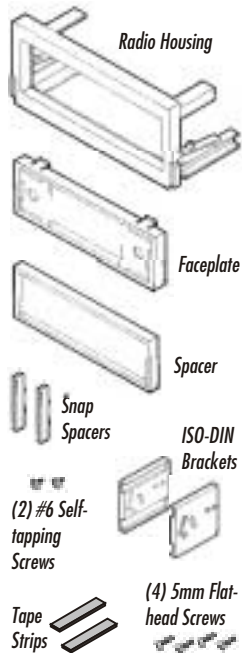

TOOLS REQUIRED



Phillips screwdriver



Cutting tool



Socket wrench



99-3002 AT-300GM AW-300GM INSTALLATION INSTRUCTIONS

APPLICATIONS

| CAR | PAGE |
|--------------------------------------|-------------|
| CADILLAC | |
| Escalade 1999-00..... | 1 |
| CHEVROLET | |
| Astro 1996-00..... | 2 |
| Express (full size van) 1996-00..... | 1 |
| Pickup 1995-00..... | 1 |
| Silverado 1999-00..... | 2 |
| Suburban 1995-00..... | 1 |
| Tahoe 1995-00..... | 1 |
| GMC | |
| Safari 1996-00..... | 2 |
| Sierra 1995-00..... | 1 |
| Suburban 1995-00..... | 1 |
| Savana (full size van) 1996-00..... | 1 |
| Yukon 1995-00..... | 1 |

☎ 1-800-221-0932 🌐 www.metraonline.com
© COPYRIGHT 2001 METRA ELECTRONICS CORPORATION

CADILLAC Escalade 1999-00 CHEVROLET Pickup/Suburban/Tahoe 1995-00 • Silverado 1999-00 GMC Sierra/Suburban/Yukon 1995-00

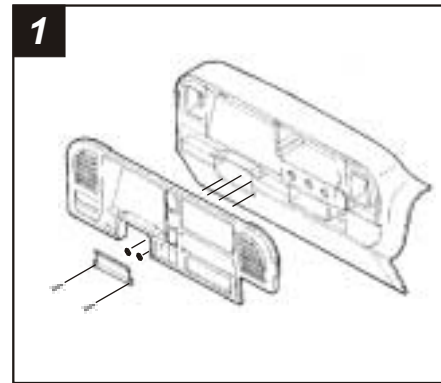

Disconnect the negative battery terminal to prevent an accidental short circuit. Remove the steering column filler panel and the ashtray. Unclip the dash trim bezel and remove. Using a small flat-blade screwdriver, press down on the outer clips of the factory head unit (or pocket). Disconnect the wiring and remove the unit.

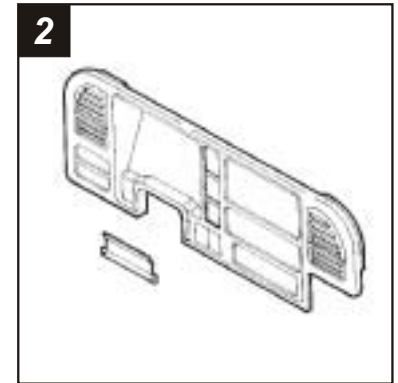

Locate the **Radio Housing**. Skip to the *Installation Instructions for ALL VEHICLES on Page #2*.

CHEVROLET Express / GMC Savana 1996-00

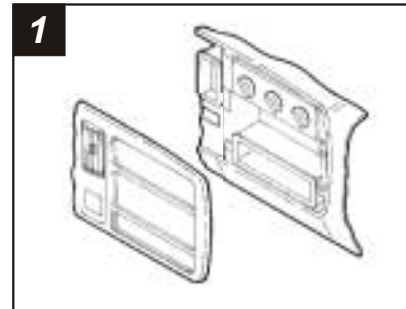

Disconnect the negative battery terminal to prevent an accidental short circuit. Unclip the plastic trim piece located below the steering column. Unclip the dash trim bezel. Pull the bezel over the steering column and disconnect the wiring. Using a flat-blade screwdriver, press down on the outside clips of the factory head unit and remove.

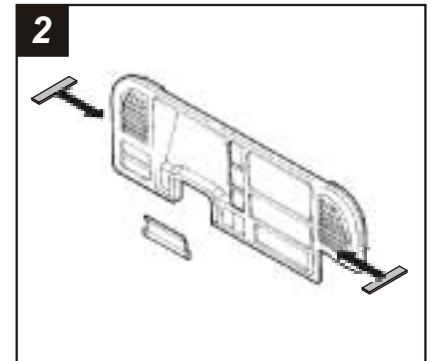

Peel away the paper backings from the **Tape Strips** and stick the Strips to the lower shelves of the mounting clips. Skip to the *Installation Instructions for ALL VEHICLES on Page #2*.

CHEVROLET Astro / GMC Safari 1996-00

1

Illustration not available when printed

Disconnect the negative battery terminal to prevent an accidental short circuit. Place the gear selector in its lowest position. Unclip the perimeter of the dash trim bezel. Disconnect the rear a/c control harness and the headlight switch from the back of the dash trim bezel and remove the bezel. Using a flat-blade screwdriver, press down on the outside clips of the factory head unit and remove.

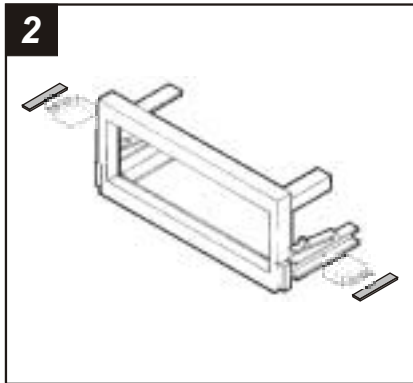

2

Peel away the paper backings from the **Tape Strips** and stick the Strips to the lower shelves of the mounting clips. Skip to the Installation Instructions for ALL VEHICLES on Page #2.

ALL VEHICLES

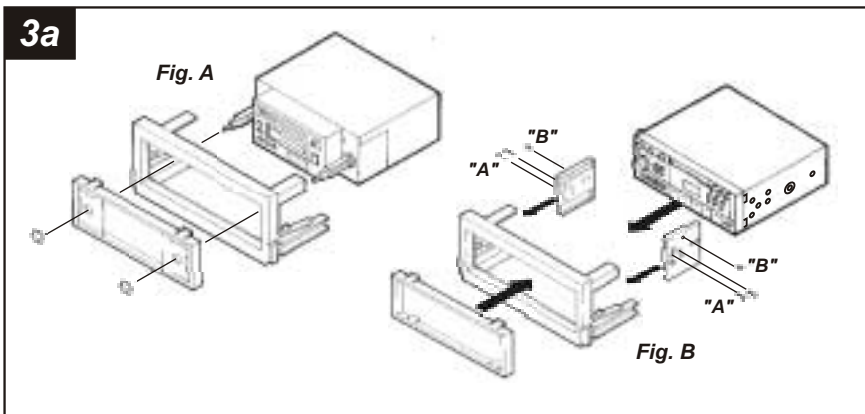

2-SHAFT HEAD UNITS: Snap the **Faceplate** into the **Radio Housing**. Slide the aftermarket head unit into the kit and secure with shaft nuts. (see Fig. A)

ISO-DIN HEAD UNITS: Cut and remove the shaft supports from the **Faceplate**. Snap the Faceplate into the **Radio Housing**. Slide the aftermarket head unit into the back of the kit. Slide the **ISO-DIN Brackets** onto the Housing legs and align the holes in the Brackets with the holes in the unit. Mount the Brackets to the unit with **(4) 5mm Flat-head Screws** supplied ("**A**"). Mount the Brackets to the top of the Housing legs with **(2) #6 Self-tapping Screws** ("**B**"). (see Fig. B)

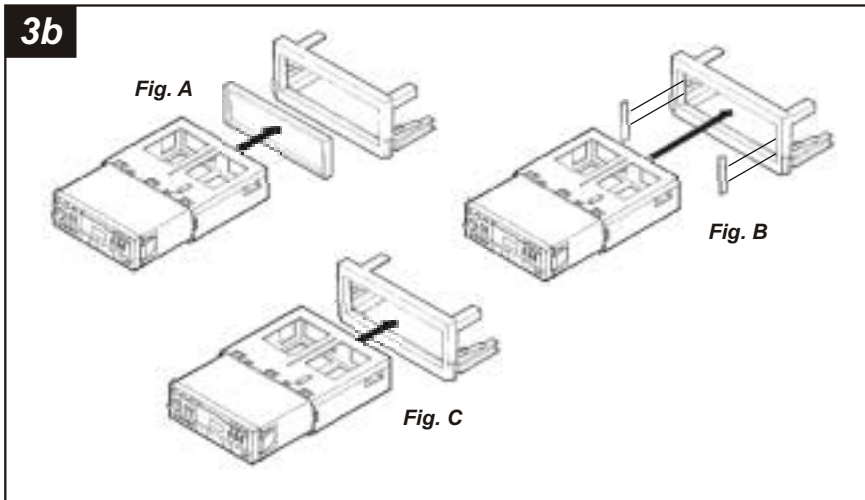

DIN HEAD UNITS: If a *surface-mount installation* is desired, cut and remove the shaft supports from the **Faceplate**. Snap the Faceplate into the **Radio Housing**. Slide the DIN cage into the kit and secure by bending the metal locking tabs down. Slide the aftermarket head unit into the cage until secure. (see Fig. A). If an *intermediate-mount installation* is desired, attach the **Snap Spacers** to the outer walls of the radio opening. Slide the DIN cage into the **Radio Housing** and secure by bending the metal locking tabs down. Slide the aftermarket head unit into the cage until secure. (see Fig. B). If a *flush-mount installation* is desired, slide the DIN cage into the **Radio Housing** and secure by bending the metal locking tabs down. Slide the aftermarket head unit into the cage until secure. (see Fig. C)

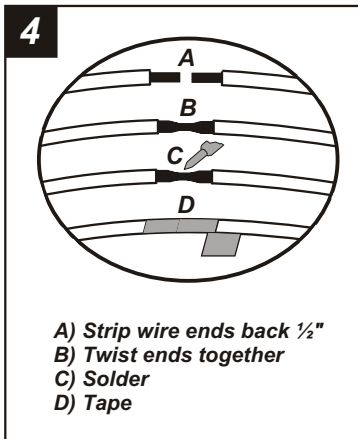

- A) Strip wire ends back 1/2"
- B) Twist ends together
- C) Solder
- D) Tape

Locate the factory wiring harness in the dash. Metra recommends using the proper mating adaptor and making connections as shown. (Isolate and individually tape off the ends of any unused wires to prevent electrical short circuit).

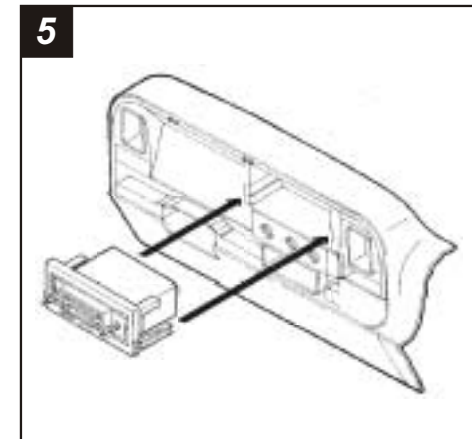

Re-connect the battery terminal and test the unit for proper operation. Slide the head unit/kit assembly into the sub-dash until the side clips engage.